



Sound Plus Adjustable TC-0135-BLA

Downlight IP23 Sound Plus Adjustable GU10 Blanco

TECHNICAL FEATURES



Structure material : Aluminium

Voltage / frequency : 100-240V/50-60Hz

Structure finish : Blanco

Warranty : 5 Years

Recommended light bulb : GU10

Energy efficiency : Light bulb not included



LUMINOTECHNIC FEATURES

Lampholder: 1 x GU10

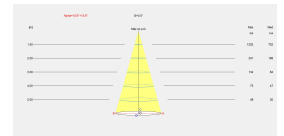

LOGISTICS

Net weight (kg): 0.12

Packaged weight (kg): 0.15

Packaging: 90mm x 65mm x 90mm



LIGHT APPLICATION

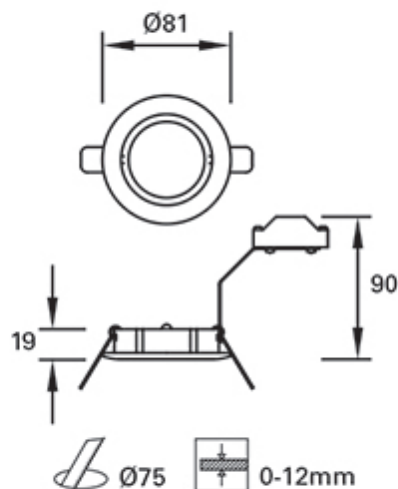

Luminaire

Code TC-0135-BLA
 Name GU10 STANDAR SOUND PLUS

Measur.

Code TC-0135-BLA
 Name GU10 STANDAR SOUND PLUS

Luminaire Flux	525.20 lm	Luminaire Power	50.00 W	Efficacy	10.50 lm/W	Efficiency	100.00%
Lamps Flux	525.20 lm	Maximum value	1202.76 cd	Position	C=0.00 G=1.00	CG	Rotosymmetrical
Round Luminaire Round Luminous Area		Diam. Diam.	80 mm 40 mm	Height Height	19 mm 1 mm		
Horizontal Luminous Area Emitting area on Plane 0° Emitting area on Plane 90°		0.001257 m2 0.000040 m2 0.000040 m2		Emitting area on Plane 180° Emitting area on Plane 270° Glare area at 76°		0.000040 m2 0.000040 m2 0.000343 m2	
Coordinate system Date Measurement Distance		CG 27-01-2016 0.00		Symmetry Type Maximum Gamma Angle Measurement Flux		Rotosymmetrical 180 525.20 lm	
Operator Temperature Humidity Notes		25.00 °C 60.00 %		Source Voltage [V] Source current [A] Photocell			

Line	Code	Luminaire Lamps Name	Flux [lm]	Pow. [W]	Q.ty
	HALOPAR 16 50W	HALOPAR 16 50W	525.20	50.00	1
C.I.E. F UTE	82 94 97 100 100 1.00 B	D DIN 5040 B NBN	A60 BZ 1		

Diam=80mm

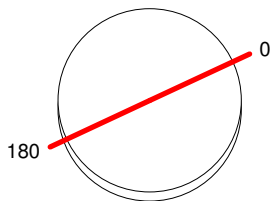

Semiplanos C

180.0 — 0.0

ULOR 0.11 %
 DLOR 99.89 %
 RN 0.11 %

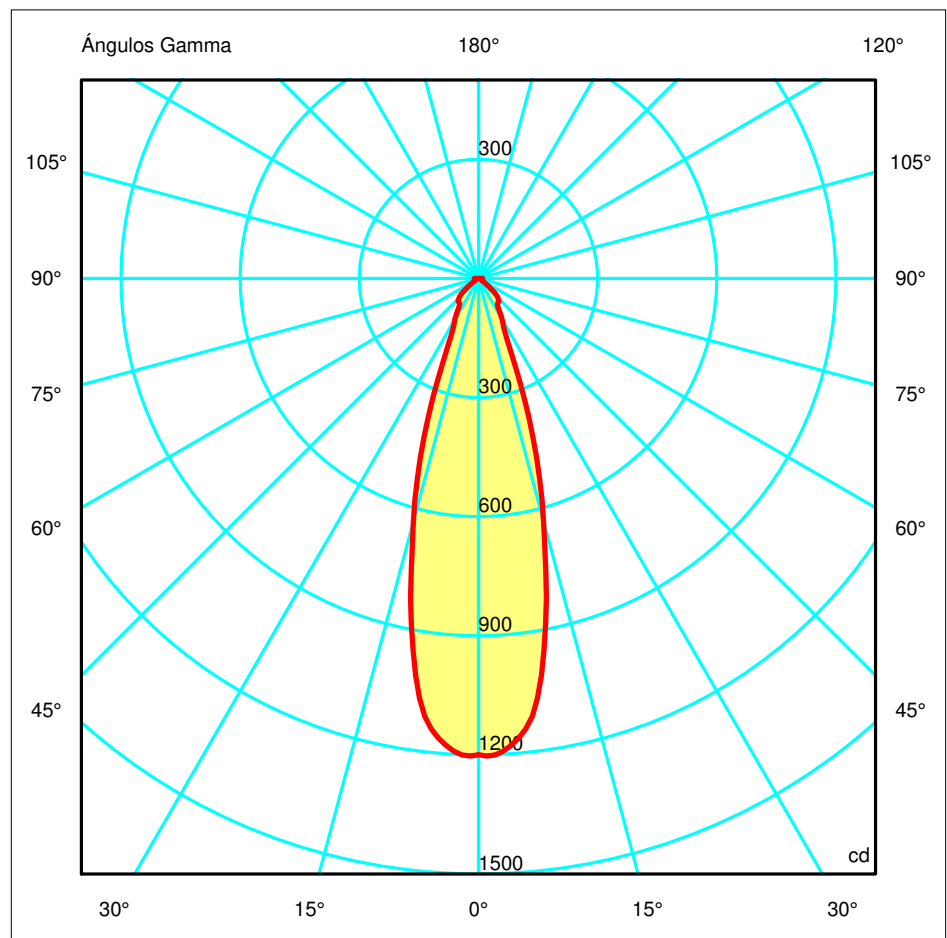

Luminaire
 Code TC-0135-BLA
 Name GU10 STANDAR SOUND PLUS
Measurem.
 Code TC-0135-BLA
 Name GU10 STANDAR SOUND PLUS

Luminaire Flux	525.20 lm	Luminaire Power	50.00 W	Efficacy	10.50 lm/W	Efficiency	100.00%
Lamps Flux	525.20 lm	Maximum value	1202.76 cd	Position	C=0.00 G=1.00	CG	Rotosymmetrical

Diam=80mm

Semiplanos C

180.0 0.0

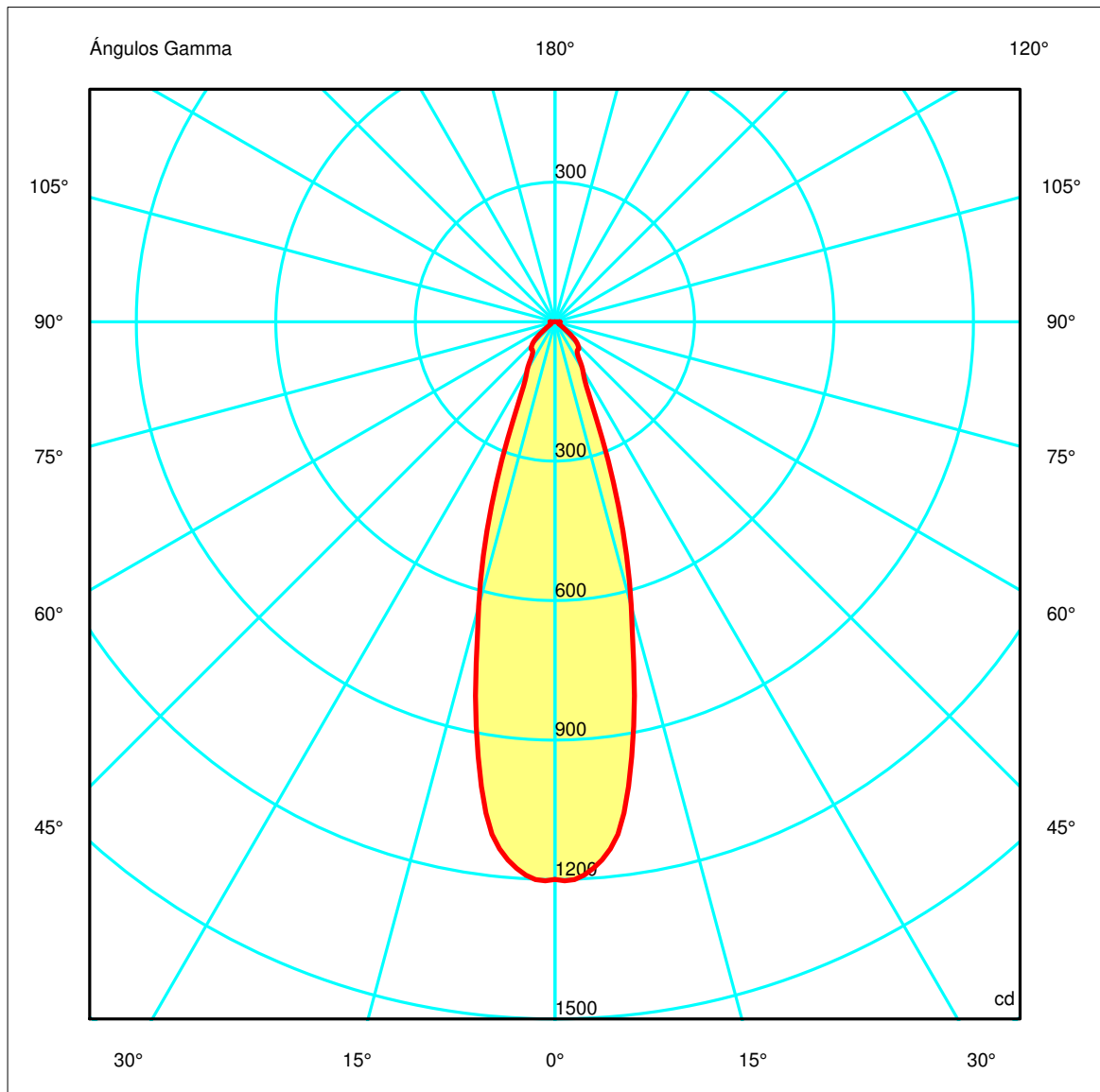
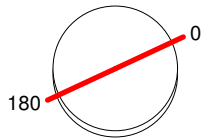

Luminaire
 Code TC-0135-BLA
 Name GU10 STANDAR SOUND PLUS
Measurement.
 Code TC-0135-BLA
 Name GU10 STANDAR SOUND PLUS

Luminaire Flux	525.20 lm	Luminaire Power	50.00 W	Efficacy	10.50 lm/W	Efficiency	100.00%
Lamps Flux	525.20 lm	Maximum value	1202.76 cd	Position	C=0.00 G=1.00	CG	Rotosymmetrical

Isolux (Floor)

Luminaire position X=0.00m Y=0.00m Z=2.50m

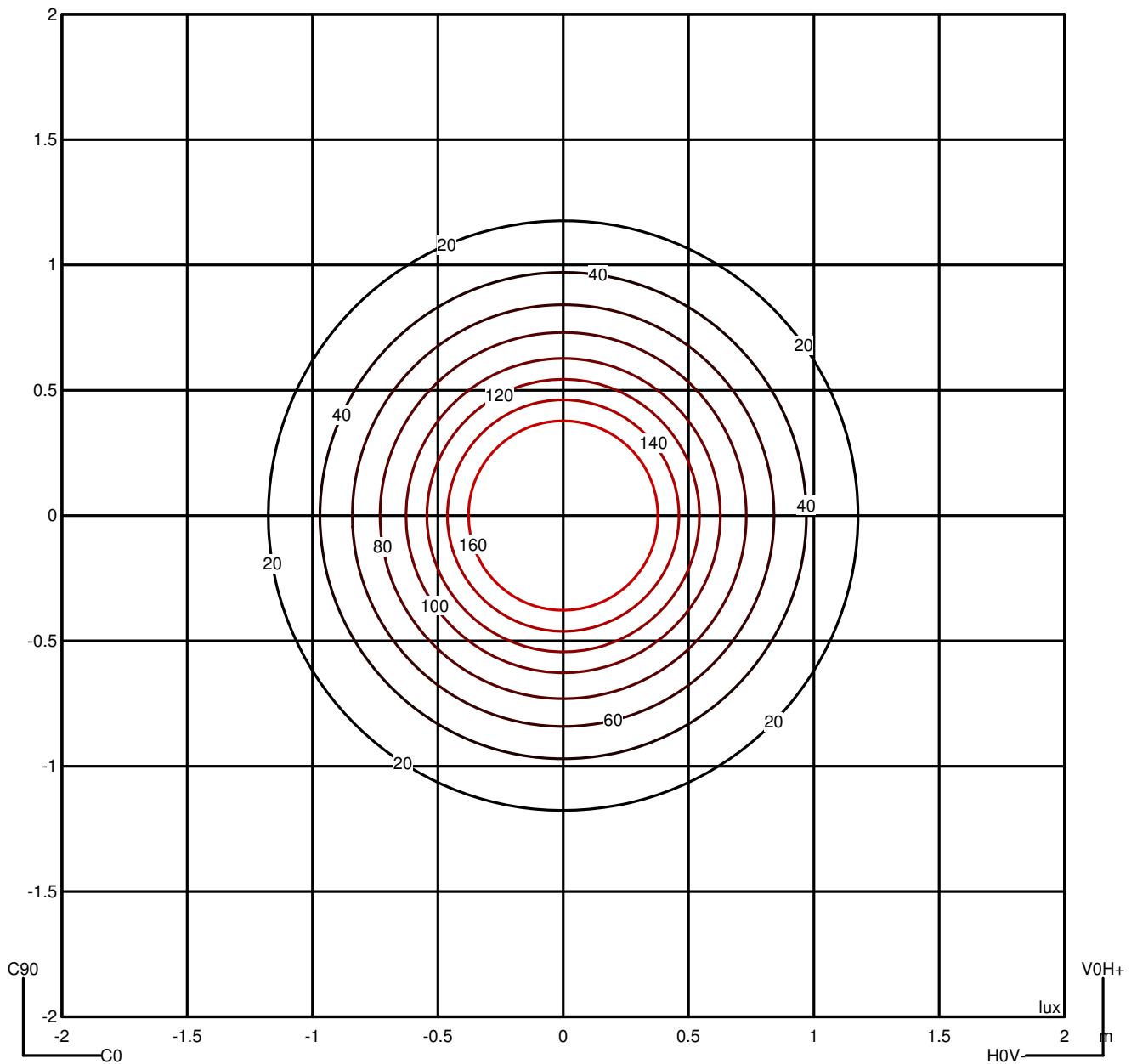

Luminaire
 Code TC-0135-BLA
 Name GU10 STANDAR SOUND PLUS
Measurement.
 Code TC-0135-BLA
 Name GU10 STANDAR SOUND PLUS

Luminaire Flux	525.20 lm	Luminaire Power	50.00 W	Efficacy	10.50 lm/W	Efficiency	100.00%
Lamps Flux	525.20 lm	Maximum value	1202.76 cd	Position	C=0.00 G=1.00	CG	Rotosymmetrical

Average Luminance [cd/m ²]										
0.0°	45°	50°	55°	60°	65°	70°	75°	80°	85°	---
	75182	54040	26684	15521	16472	22241	26836	34442	62913	

Flujo montado o vista longitudinal												
		Iluminancia (lx)										
A	A	2000	1000	750	500		<300					1.15
B	1		2000	1500	1000	750	500	<300				1.5
C					2000		1000	500	<300			1.85
D	2						2000	1000	500	<300		2.2
E	3							2000	1000	500	<300	2.55

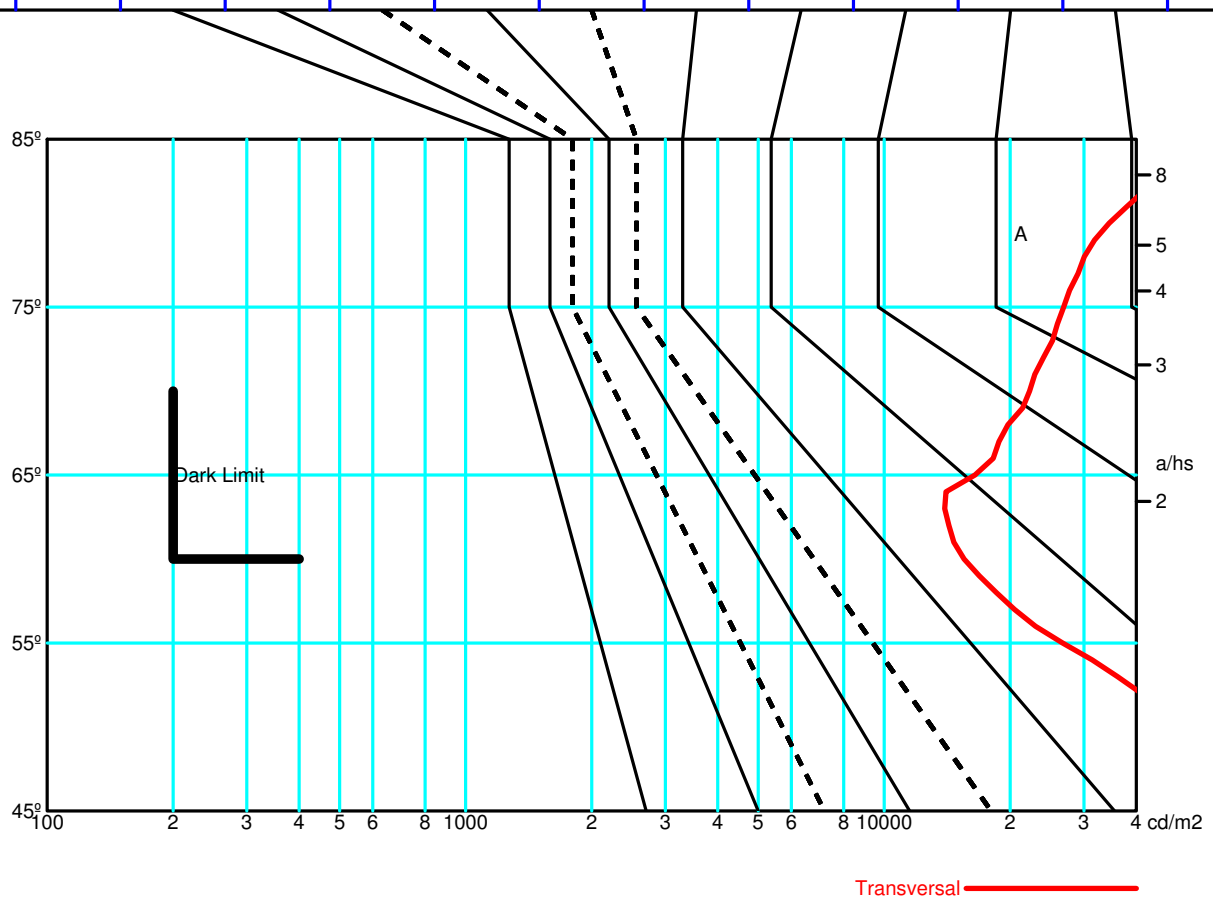

Luminaire

Code TC-0135-BLA
 Name GU10 STANDAR SOUND PLUS

Measur.

Code TC-0135-BLA
 Name GU10 STANDAR SOUND PLUS

Luminaire Flux	525.20 lm	Luminaire Power	50.00 W	Efficacy	10.50 lm/W	Efficiency	100.00%
Lamps Flux	525.20 lm	Maximum value	1202.76 cd	Position	C=0.00 G=1.00	CG	Rotosymmetrical

Diam=80mm

Semiplanos C

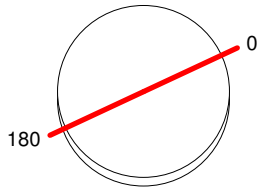

180.0 ————— 0.0

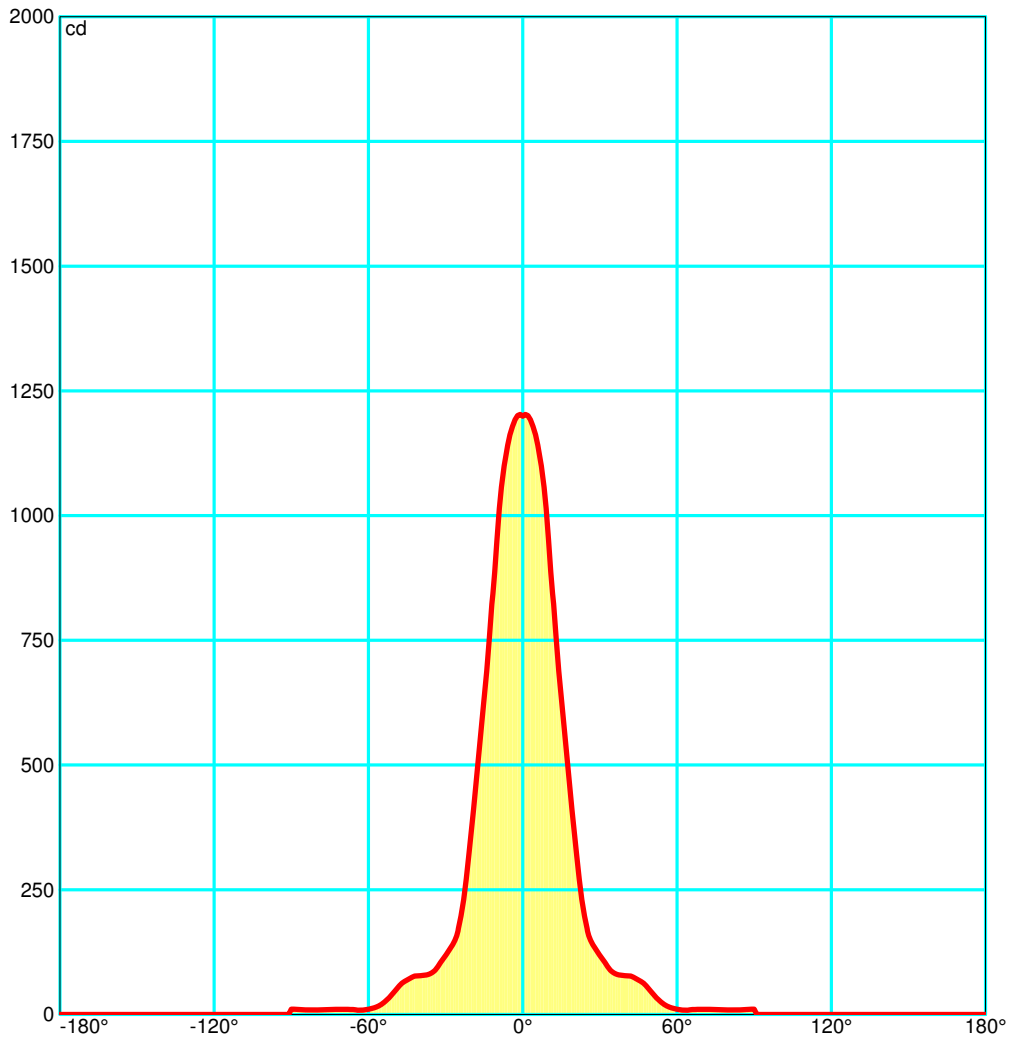



Luminaire

Code TC-0135-BLA
Name GU10 STANDAR SOUND PLUS

Measurerm.

Code TC-0135-BLA
Name GU10 STANDAR SOUND PLUS

Luminaire Flux	525.20 lm	Luminaire Power	50.00 W	Efficacy	10.50 lm/W	Efficiency	100.00%
Lamps Flux	525.20 lm	Maximum value	1202.76 cd	Position	C=0.00 G=1.00	CG	Rotosymmetrical

UGR
S = 0.250

Reflectancies										
Ceiling/Cavity	0.7	0.7	0.5	0.5	0.3	0.7	0.7	0.5	0.5	0.3
Walls	0.5	0.3	0.5	0.3	0.3	0.5	0.3	0.5	0.3	0.3
WorkingPlane	0.2	0.2	0.2	0.2	0.2	0.2	0.2	0.2	0.2	0.2
RoomDimensions	ViewedCrosswise					ViewedEndwise				
x=2H y=2H	21.4	22.3	21.7	22.5	22.7	21.4	22.3	21.7	22.5	22.7
x=2H y=3H	22.0	22.8	22.3	23.0	23.3	22.0	22.8	22.3	23.0	23.3
x=2H y=4H	22.6	23.3	22.9	23.6	23.8	22.6	23.3	22.9	23.6	23.8
x=2H y=6H	23.4	24.1	23.7	24.4	24.6	23.4	24.1	23.7	24.4	24.6
x=2H y=8H	24.0	24.6	24.3	24.9	25.2	24.0	24.6	24.3	24.9	25.2
x=2H y=12H	24.7	25.4	25.1	25.7	26.0	24.7	25.4	25.1	25.7	26.0
x=4H y=2H	21.5	22.2	21.8	22.5	22.7	21.5	22.2	21.8	22.5	22.7
x=4H y=3H	22.4	23.0	22.7	23.3	23.6	22.4	23.0	22.7	23.3	23.6
x=4H y=4H	23.2	23.8	23.6	24.1	24.5	23.2	23.8	23.6	24.1	24.5
x=4H y=6H	24.3	24.8	24.8	25.2	25.6	24.3	24.8	24.8	25.2	25.6
x=4H y=8H	25.1	25.5	25.5	25.9	26.3	25.1	25.5	25.5	25.9	26.3
x=4H y=12H	26.1	26.5	26.6	26.9	27.3	26.1	26.5	26.6	26.9	27.3
x=8H y=4H	23.7	24.1	24.1	24.5	24.9	23.7	24.1	24.1	24.5	24.9
x=8H y=6H	25.1	25.4	25.5	25.8	26.3	25.1	25.4	25.5	25.8	26.3
x=8H y=8H	26.1	26.4	26.5	26.8	27.3	26.1	26.4	26.5	26.8	27.3
x=8H y=12H	27.3	27.6	27.8	28.0	28.5	27.3	27.6	27.8	28.0	28.5
x=12H y=4H	23.8	24.1	24.2	24.5	25.0	23.8	24.1	24.2	24.5	25.0
x=12H y=6H	25.3	25.6	25.8	26.0	26.5	25.3	25.6	25.8	26.0	26.5
x=12H y=8H	26.4	26.7	26.9	27.1	27.6	26.4	26.7	26.9	27.1	27.6

Luminaire

Code TC-0135-BLA
Name GU10 STANDAR SOUND PLUS

Measur.

Code TC-0135-BLA
Name GU10 STANDAR SOUND PLUS

Luminaire Flux	525.20 lm	Luminaire Power	50.00 W	Efficacy	10.50 lm/W	Efficiency	100.00%
Lamps Flux	525.20 lm	Maximum value	1202.76 cd	Position	C=0.00 G=1.00	CG	Rotosymmetrical

Pavement			Road		
Piano	0	0.00%	Piano	0	0.00%
Piano	-5	11.82%	Piano	5	11.82%
Piano	-10	22.22%	Piano	10	22.22%
Piano	-15	30.08%	Piano	15	30.08%
Piano	-20	35.40%	Piano	20	35.40%
Piano	-25	38.74%	Piano	25	38.74%
Piano	-30	41.16%	Piano	30	41.16%
Piano	-35	43.10%	Piano	35	43.10%
Piano	-40	44.74%	Piano	40	44.74%
Piano	-45	46.12%	Piano	45	46.12%
Piano	-50	47.10%	Piano	50	47.10%
Piano	-55	47.66%	Piano	55	47.66%
Piano	-60	48.02%	Piano	60	48.02%
Piano	-65	48.33%	Piano	65	48.33%
Piano	-70	48.66%	Piano	70	48.66%
Piano	-75	48.99%	Piano	75	48.99%
Piano	-80	49.29%	Piano	80	49.29%
Piano	-85	49.60%	Piano	85	49.60%
Piano	-90	49.94%	Piano	90	49.94%

Ángulo de Inclinación = 0.0

DLOR = 99.89%

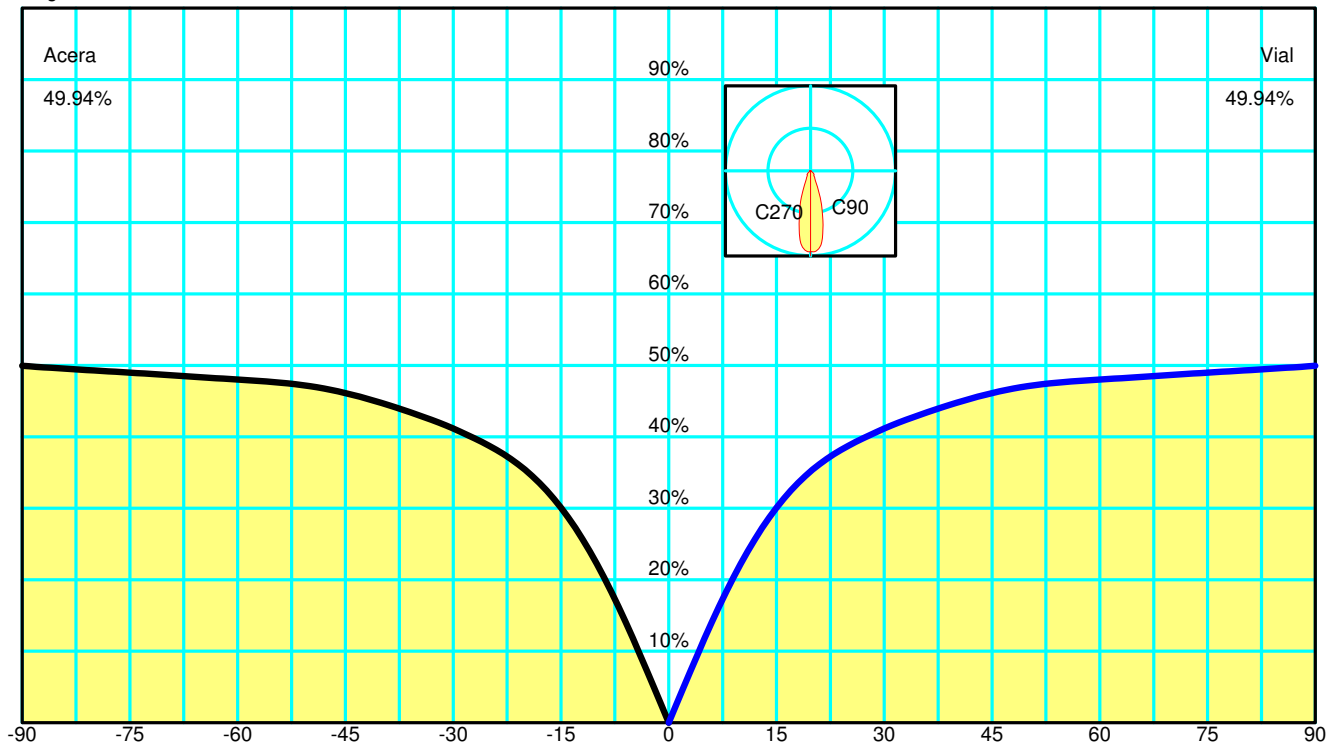

Spread 7.6° Estrecho
Throw 3.8° Corto

Cutoff CIE Semi Cutoff - Max: C=0.0° Gamma=1.0°
Cutoff Iesna Cutoff
DIN5044 KB2

IESNA Type V Very Short Quadrilateral Symmetry

DLOR 99.88874 %
ULOR 0.11126 %
Rendimiento 100.00000 %
RN 0.11126 %
Clase de Intensidad Luminosa G2
Índice de Deslumbramiento D5

Luminaire
 Code TC-0135-BLA
 Name GU10 STANDAR SOUND PLUS
Measurment.
 Code TC-0135-BLA
 Name GU10 STANDAR SOUND PLUS

Luminaire Flux	525.20 lm	Luminaire Power	50.00 W	Efficacy	10.50 lm/W	Efficiency	100.00%
Lamps Flux	525.20 lm	Maximum value	1202.76 cd	Position	C=0.00 G=1.00	CG	Rotosymmetrical

US ROAD STANDARDS

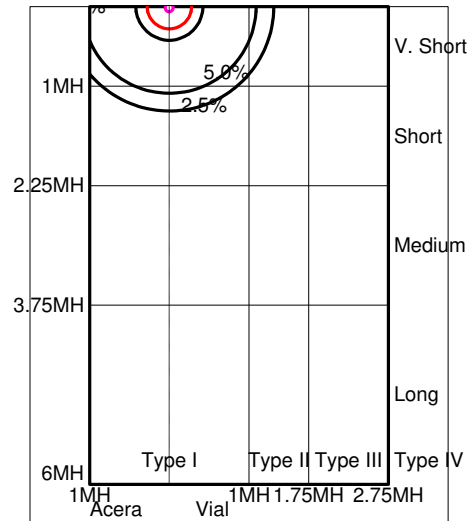
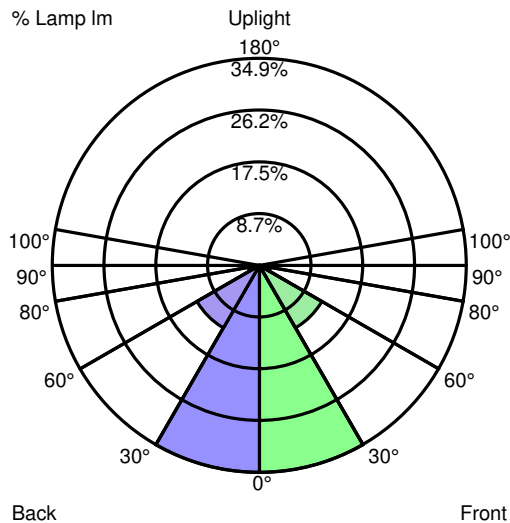

Luminaire Classification System (LCS)				
LCS Zone		Lumens	%Lamp	%Lum
FL	0° -- 30°	183.4 lm	34.9 %	34.9 %
FM	30° -- 60°	63.9 lm	12.2 %	12.2 %
FH	60° -- 80°	9.8 lm	1.9 %	1.9 %
FVH	80° -- 90°	5.2 lm	1.0 %	1.0 %
BL	0° -- 30°	183.4 lm	34.9 %	34.9 %
BM	30° -- 60°	63.9 lm	12.2 %	12.2 %
BH	60° -- 80°	9.8 lm	1.9 %	1.9 %
BVH	80° -- 90°	5.2 lm	1.0 %	1.0 %
UL	90° -- 100°	0.6 lm	0.1 %	0.1 %
UH	100° -- 180°	0.0 lm	0.0 %	0.0 %
TOTALS		525.2 lm	100.0 %	100.0 %
BUG B1 U1 G0 Type V Very Short Quadrilateral Symmetry				

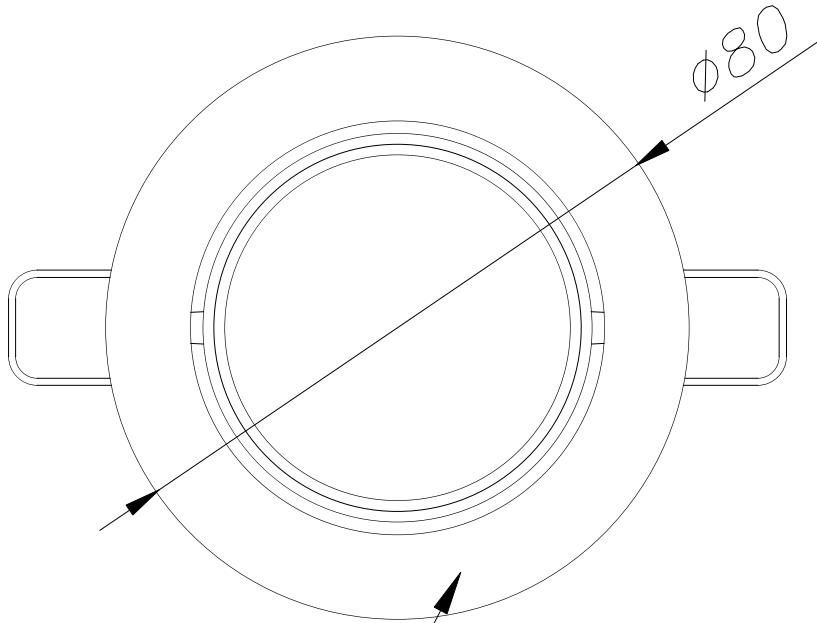

ALUMINIO INYECTADO
INJECTED ALUMINIUM

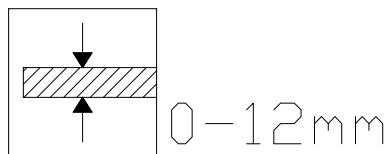
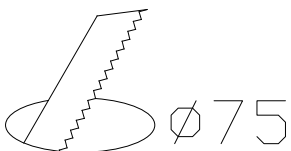
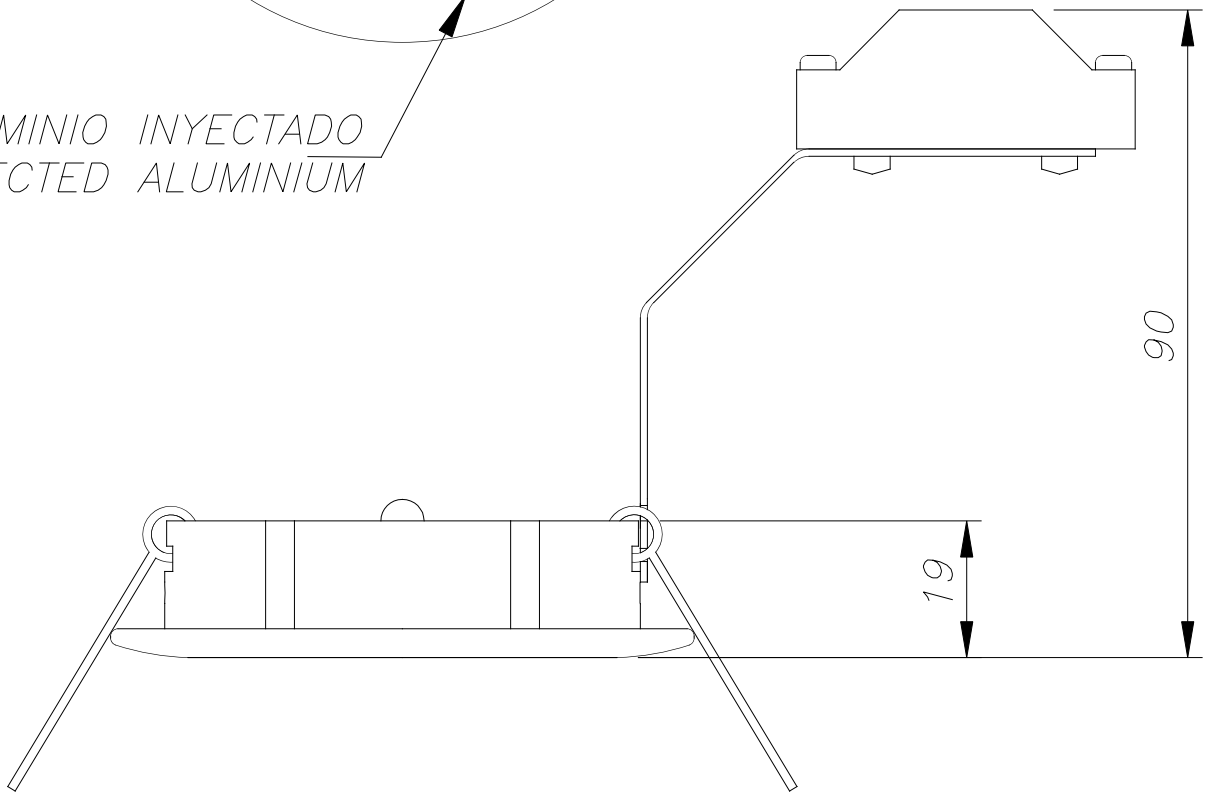

Scale 1:1

